

---

# HEADPHONE STAND HPS-H

---



## INSTALLATION GUIDE

## What's in the box?



- ① Pillar
- ② Hex wrench
- ③ Hex screw
- ④ Base
- ⑤ Beam

- ❖ Full aluminum
- ❖ 3/4" thick base
- ❖ 5/16" thick pillar
- ❖ 1/2" thick beam
- ❖ External dimension: 10<sup>1</sup>/<sub>2</sub>"(H), 3<sup>1</sup>/<sub>2</sub>"(W), 3<sup>1</sup>/<sub>2</sub>"(D)
- ❖ Weight: 1 pound

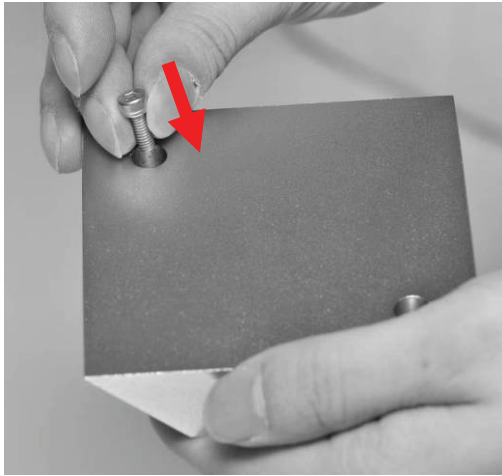

1

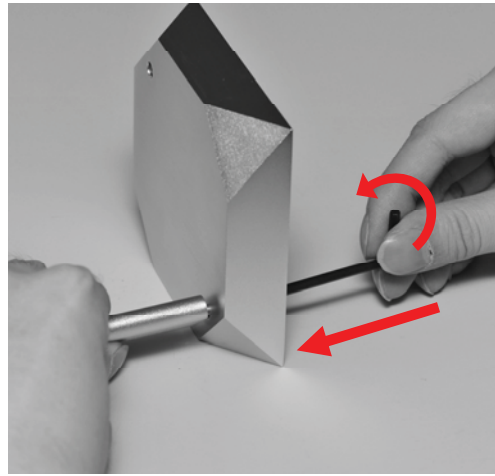

2

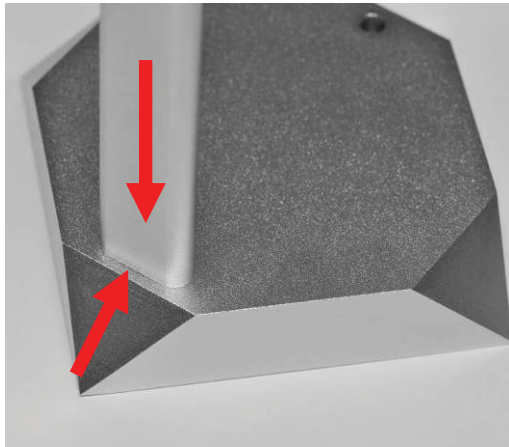

3

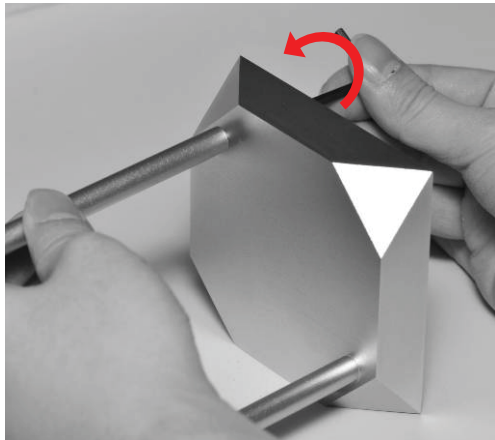

4



5



6