

music hall  
**classic**

INSTRUCTION MANUAL

music hall  
<http://www.musichallaudio.com>

## IMPORTANT SAFETY INSTRUCTIONS

1. Read these instructions carefully.
2. Keep these instructions for later reference.
3. Heed all warnings.
4. Follow all instructions.
5. Do not use the device near water.
6. Clean only with a dry cloth.
7. Do not block any ventilation openings. Always ensure a sufficient ventilation. Install in accordance with the manufacturer's instructions.
8. Do not install near any heat sources such as radiators, heat registers, stoves, or other devices (including amplifiers) that produce or radiate heat.
9. Do not defeat the safety purpose of the polarized or grounding-type plug. A polarized plug has two blades, one being wider than the other. A grounding-type plug has two blades and a third grounding prong. The wide blade or the third prong is provided for your safety. If the provided plug does not fit into your outlet, consult an electrician for replacement of the obsolete outlet.
10. Protect the power cord from being walked on or pinched or otherwise damaged, particularly at plugs, convenience receptacles, and the point where they exit from the device.
11. Only use attachments/accessories that have been specified by the manufacturer.
12. Use only with a cart, stand, tripod, bracket or table specified by the manufacturer, or sold along with the device. When a cart is used, use caution when moving the cart/device combination to avoid injury from tip-over.
13. Unplug this device during lightning storms or when not being used for longer periods of time.
14. Refer all servicing to qualified service personnel only. Servicing is required when the device has been damaged in any way, such as: Power-supply cord or plug has been damaged, liquid has been spilled or entered the device, the device has been exposed to rain or moisture, or objects have fallen into the device, the device does not work normally, or it has been dropped.
15. Please keep the unit in a good ventilation environment at any time.



 The lightning flash with the arrowhead symbol within the equilateral triangle is intended to alert the user to the presence of un-insulated "dangerous voltage" within the product's enclosure that may be of sufficient magnitude to constitute a risk of an electrical shock.

*Le symbole de l'éclair terminé par une flèche situé à l'intérieur d'un triangle équilatéral avertit l'utilisateur de la présence de tension dangereuse non isolée dans l'appareil, dont l'amplitude peut constituer un risque de choc électrique.*

 The exclamation point within the equilateral triangle is intended to alert the user to the presence of important operation and maintenance (servicing) instructions in the literature accompanying this appliance.

*Le symbole du point d'exclamation dans un triangle équilatéral vise à avertir l'utilisateur de la présence, dans la documentation accompagnant cet appareil, d'importantes instructions de fonctionnement et d'entretien.*

### WARNING!/ AVERTISSEMENT!

To reduce the risk of fire or an electrical shock, do not expose this device to rain or moisture. The device must not be exposed to dripping or splashing water. Furthermore no objects filled with liquids, such as vases, shall be placed on the device.

*Afin de réduire les risques d'incendie ou de choc électrique, n'exposez pas cet appareil à la pluie et à l'humidité. L'appareil ne doit pas être exposé au ruissellement ni à la projection d'eau et aucun objet contenant un liquide, tel qu'un vase, ne doit être posé dessus.*



**CAUTION:** In order to reduce the risk of an electrical shock, do not remove any cover. There are no user-serviceable parts inside the device. Refer servicing to qualified service personnel only.

**ATTENTION :** Pour réduire le risque de choc électrique, ne déposez aucun capot. L'appareil ne contient aucun composant réparable par l'utilisateur. Toute réparation doit être confiée à un centre de services qualifié.

Caution Marking and rating plate was located at rear enclosure of the apparatus.

*Avertissement La plaque signalétique est située à l'arrière de l'appareil.*

When the mains plug or appliance coupler is used as disconnect device, it shall remain readily operable.

*lorsque la prise du RESEAU D'ALIMENTATION sur l'appareil est utilisée comme appareil de déconnexion, cet appareil doit demeurer aisément accessible.*

The ventilation should not be impeded by covering the ventilation openings with items, such as newspapers, table-cloths, curtains, etc.; Minimum distances 10cm around the apparatus for sufficient ventilation.

*Il convient que l'aération ne soit pas gênée par l'obstruction des ouvertures d'aération par des objets tels que journaux, nappes, rideaux, etc.; Distance minimale 10cm autour de l'appareil pour une aération suffisante.*

No naked flame sources, such as lighted candles, should be placed on the apparatus;

*il convient de ne pas placer sur l'appareil de sources de flammes nues, telles que des bougies allumées.*

Use the apparatus only in a moderate climate.

*N'utiliser l'appareil que dans des climat modéré.*

## SETUP and ASSEMBLY

Some assembly is required before you can begin to use your new unit.  
Please follow the assembly instruction below before attempting to use your new turntable.

**NOTE:** Do not connect your turntable to a power outlet with the AC adaptor until you are finished with assembly.  
Do not remove the twist tie for clamping the tone arm until assembly is completed.

### PRECAUTIONS ON PLACEMENT:

1. Do not place the unit in a location where it will be exposed to direct sunlight or near any type of heating appliance.
2. Do not place the unit in a location where there is high humidity or a lot of dust.
3. Cartridge may pick up slight sound pressure or vibrations of nearby speakers. For best results, do not install this unit too close to speakers.
4. Install this unit on a horizontal surface that is stable and vibration free.
5. The rubber feet have been specially designed to isolate the unit from excess vibration. The feet may also be used to stabilize the main body horizontally.

### ASSEMBLY

1. Remove the main unit with the packing from the box and remove the packing.
2. Set the turntable platter onto the center spindle.

#### VERY IMPORTANT!!

Do not forget to attach rubber belt to motor for correct operation. After placing the Turntable Platter onto the turntable through the Center Spindle, move one of the large windows on the Platter to top right corner. Attach rubber belt around motor. (Rubber belt is already attached to the underside of the Turntable Platter.)

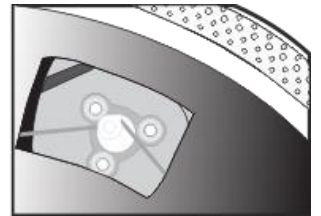

3. Set the platter mat on the platter.
4. Installation of cartridge:  
When installing a cartridge, refer to the operating instructions of that cartridge.  
During installation, attach the stylus protector to guard the stylus tip from damage.
  - (a) Connect the lead wires to the cartridge terminals. The terminals of most cartridges are color-coded.  
Connect each lead wire to the terminal of the same color.

White (L+)	Left channel+
Blue (L-)	Left channel-
Red (R+)	Right channel+
Green (R-)	Right channel-
  - (b) Install the cartridge to the headshell and tighten it with screws provided with the cartridge.
5. Insert the headshell with pre-mounted cartridge into the front end of the tone arm, and then turn the lock nut counterclockwise with the headshell firmly held horizontally.
6. Slide counterweight on the tone arm. Twist it lightly and it will screw onto the rear shaft of the tone arm. Advancing the counterweight to the white line will give you an effective tracking force of 2.0g and allow you to skip step #7.
7. Adjustment of horizontal "zero" balance and stylus pressure:
  - (a) Remove the stylus protector from the headshell, do not touch the stylus tip during the adjustment.
  - (b) Set the cueing lever to the lowered position.
  - (c) Release the tone arm clamp and lift the tone arm from the arm rest to free it.
  - (d) Rotate the counterweight until the tone arm is approximately balanced horizontally (floats freely).
  - (e) Refasten the tone arm with the tone arm clamp.
  - (f) Hold the counterweight stationary with one hand and rotate only the stylus-pressure ring to bring the number "0" of the ring into alignment with the center line on the tone arm rear shaft.
  - (g) Rotate the counterweight including the stylus-pressure ring counterclockwise until the scale shows the value corresponding to the pressure of the stylus used. Should you use a separate Stylus, please follow the correct tracking force as specified by the manufacturer's instructions. The tracking force for the included cartridge is 2.0 grams.
8. Set the anti-skating control knob to the same value as the stylus pressure.
9. Install the dust cover to the main unit's dust cover hinges.

## PART NAMES and FUNCTIONS

### FRONT & REAR PANEL

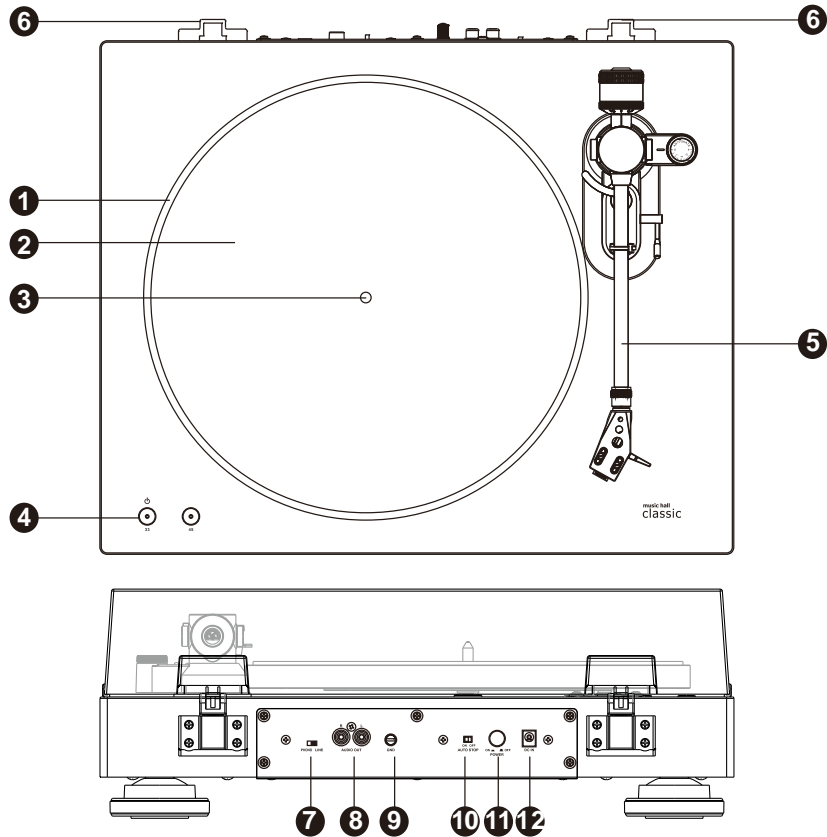

#### 1. Platter

Place the platter on the spindle while you are assembling your turntable. It has a drive belt wound around on the underside.

#### 2. Platter mat

#### 3. Spindle

#### 4. Speed buttons

Touch speed buttons to select the appropriate rotation speed to play vinyl record, and touch one more time you can stop playback.

“33” button LED lights red when power on by POWER ON/OFF button on the rear panel.

The selected speed LED lights blue during playback, and LED will flash approximately end of playback when the automatic stop function is on.

#### 5. Tone arm part

For details, refer to “Tone arm” paragraph.

#### 6. Dust cover hinge holders

Attachment points for dust cover hinges.

#### 7. PHONO/LINE switch

Use this switch to select the audio output type appropriate to your connected audio device, such as a stereo system or an amplifier. If plugging into a phono input make sure the switch is set to PHONO. If plugging into a line input make sure the switch is set to LINE.

#### 8. AUDIO OUTPUT Terminals

## PART NAMES and FUNCTIONS

### 10. AUTO STOP ON/OFF switch

Press Auto stop on/off on the rear panel to turn the automatic stop function on.

It will automatically raises the tone arm and stop the turntable at the end of playback.

You can touch the selected speed button to restart playback.

### 11. POWER ON/OFF button

### 12. DC IN

## TONARM

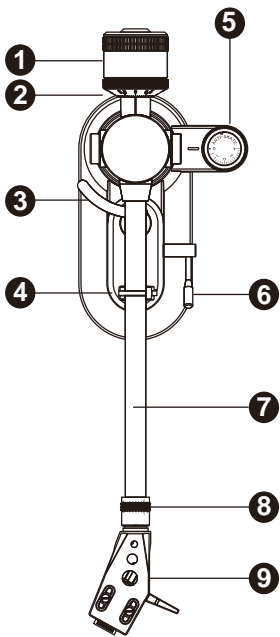

#### 1. Counterweight

Balances the tone arm and adjusts to provide the proper tracking force.

#### 2. Tracking force gauge ring

Use to adjust the tracking force

#### 3. Tone arm lift

Moves the tone arm vertically to and from the surface of the record.

#### 4. Tone arm rest

#### 5. Anti-skate control dial

While the record is playing, a force acts on the stylus tip to pull it inward. This force can be counteracted by setting the same values for anti-skate and the tracking force.

#### 6. Tone arm lift control lever

Operates the tone arm lift.

#### 7. Tone arm

#### 8. Locking ring

Rotate the ring to the left (counterclockwise) to secure the headshell. To remove the headshell, rotate the ring to the right.

#### 9. Headshell and cartridge

The cartridge is mounted to the headshell.

## CONNECTION

Before connecting the unit, it is advised that you also consult your current equipment instruction manual.

**IMPORTANT:** Be sure to turn off the equipment before you make changes to the different connections.

1. Connect the AC adapter to an AC outlet.
2. Connect the RCA cable to the PHONO input of your AMPLIFIER.

Output terminals	Amplifier (Receiver)
L (White)	L Channel
R (Red)	R Channel
GND (Spade)	GND

### NOTE:

Be sure to connect the ground terminal firmly to the amplifier or receiver to avoid pops.

If this connection is not made or is loose, a power source "HUM" will result.

You can also use a line input by setting the PHONO/LINE switch at the rear of the turntable to LINE.

**\*When using the LINE input the ground connection is not required\***

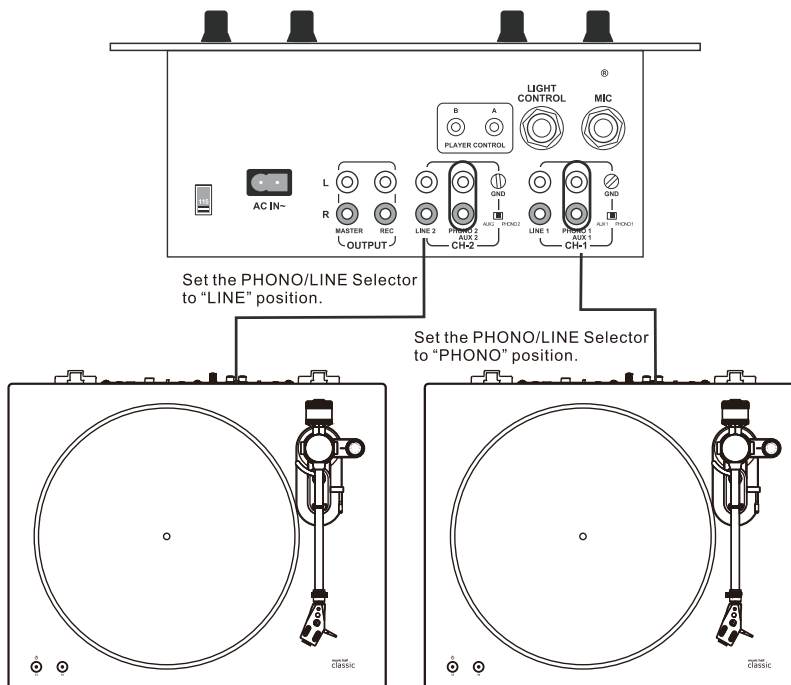

## PLAYING A RECORD

Before you play a record, turn down the volume of the connected audio device (an amplifier, speakers, etc.) to avoid a possible loud crackling noise. The crackling noise made by the stylus coming into contact with the vinyl record could damage the audio device. Wait until the stylus is completely placed on the vinyl record, and then turn up the volume.

1. Place a record onto the platter.

**NOTE:** Place only one vinyl record on the platter at a time.

To play a 17 cm (7 inch) vinyl record, place the supplied 45 rpm adaptor on the spindle.

2. Touch the SPEED buttons to select the rotation speed appropriate to the vinyl record.
3. Unlock the tone arm lock and push the tone arm lifter lever toward the back of the turntable. The tone arm slowly ascends.
4. Gently hold the headshell to move the tone arm to the position over the desired track.
5. Pull the tone arm lifter lever toward the front of the turntable. The tone arm slowly descends and playback starts. To stop the playback before it finishes, touch the selected SPEED button again and the playback stops. Push the tone arm lifter lever toward the back of the turntable, the tone arm slowly ascends

**NOTE:** • When closing the dust cover, close it slowly to avoid making physical force that may cause the stylus to skip.

- During playback, keep your hands away from the tone arm and the turning vinyl record.
- During playback, do not stop the rotation of the platter by hand.

## PLAYBACK IS FINISHED

1. Push the tone arm lifter lever toward the back of the turntable.
2. Move the tone arm back to the tone arm rest.
3. Press the POWER ON/OFF button to turn off your turntable.

## SPECIFICATION

### 1. GENERAL SECTION

Power Supply	DC12V · 2.0A 
Dimensions	435(W) x 367(D) x 157(H) mm
Weight	6.9Kg

### 2. FEATURES

Turntable Type	2-speed semi-automatic
Cartridge Type	Moving magnetic cartridge
Motor	DC motor
Driving Method	Belt drive
Turntable Platter	305mm dia. Aluminum die-cast
Speed	33 <sup>1</sup> / <sub>3</sub> and 45rpm

### 3. Performances

Speed Tolerance	3000Hz +/-0.3%(CD-4005)
Channel Separation	More than 18 dB at 1KHz (CD-4005)
Channel Balance	Within 2.5 dB at 1KHz (CD-4005)
Phono Output Level	2.48~4.95 mV at 1KHz 5cm/sec (CD-4005)
Line Output	156~312 mV at 1KHz 5cm/sec (CD-4005)
RIAA	20Hz~20KHz: +1/-3 dB
Wow and Flutter	TYPICAL: Less than 0.12% WTD at 3KHz RMS(CD-4005) LIMIT: Less than 0.15% WTD at 3KHz RMS(CD-4005)
S/N Ratio for MM	TYPICAL: More than 65dB (DIN-B) (SS-4242) LIMIT: More than 62dB (DIN-B) (SS-4242)

Noise floor

#### **Power on, Platter stop and cartridge touch vinyl.**

Line output more than 80dB (with 20KHz Low Pass Filter/ "IHF-A" weighted).

#### **Power on, Platter rotate and cartridge not touch vinyl.**

Line output more than 87dB (with 20KHz Low Pass Filter/"IHF-A" weighted).

### 4. Cartridge: CN-5534

Output Voltage	3.5mV +/- 3dB at 1KHz (3.54cm/sec)
Channel Separation	More than 18dB(AT6606A)
Channel Balance	Within 2.5dB at 1KHz(AT6606A)
Frequency Response	0 +/- 3dB at Measurement point 10KHz/1KHz
Suggested stylus force	2.0 ±0.5 g

### 5. TONEARM SECTION

Type	Static balanced straight shaped w/soft-damping control
Effective Arm Length	221.5mm
Arm Lifter	Oil damper type with Auto Lifter-up function
Time for Lifter Down	1~3 sec (At 2.0g stylus force)
Height of Needle	8~12mm (At lifter up)
Overhang	19mm
Offset angle	25.61°
Tracking Error Angle	3 degree or less
Stylus Force adjustment method	Rotation movability
Range of Needle Pressure Adjustment	0~4g (0.5g/ Scale Work Smoothly)
Range of Anti-skating Adjustment	0~4g
Bearing (Vertical)	Pivot Bearing
Head Shell	Aluminum, Removable
Connector for Head Shell	EIAJ Standard 4p Con.



## SPECIFICATION

### 6. ACCESSORIES SUPPLIED

Instruction manual x 1	45 rpm adaptor x 1	2P RCA Cable x 1
Counter weight x 1	Power Adapter x 1	Dust cover x 1
Platter mat x 1	Hinge x 2	Platter + Belt x1
Headshell assembly x 1	Transfer plug adaptors x 3 (UL/PSEX1, VDEX1, UKX1)	

### 7. NOTES

- (1) The specifications are subject to change to any improvement by negotiations in advance.
- (2) The parts are subject to change to any improvement within the range of the specifications.

## **WARRANTY**

This entitles you to have the music hall classic repaired free of charge, at our discretion, for one year after the date of purchase, at any authorized Music Hall Service Center, provided the unit was purchased from an authorized dealer. Your original sales receipt is proof of purchase date. Music Hall takes no responsibility for defects arising from accident, misuse, abuse, wear and tear, neglect or unauthorized repair and/or adjustment. Music Hall cannot accept responsibility for damage or loss that occurs during transit.

The warranty does not cover transportation costs.

### **CLAIMS UNDER WARRANTY**

The turntable should be packed in the original packing and returned to the dealer from whom it was purchased, or, upon authorization, to a Music Hall Service Center. It should be sent by a reputable carrier, carriage prepaid. Do not send the turntable via USPS (United States Postal Service). Since no responsibility will be accepted for a unit in transit to the dealer, customer, or authorized service agent, customers are advised to insure against loss, damage, or theft.

### **FOR FURTHER INFORMATION CONTACT:**

music hall

108 Station Road

Great Neck, NY 11023

Tel: 516-487-3663

Fax: 516-773-3891

<http://www.musicchallaudio.com>



**music hall**  
**classic**